



ASSEMBLY INSTRUCTIONS

Works with – S Series | R Series | EL Series | W Series | SOL Series

What you'll need:

 = Provided  = Purchased Separately (click on each product to purchase online)

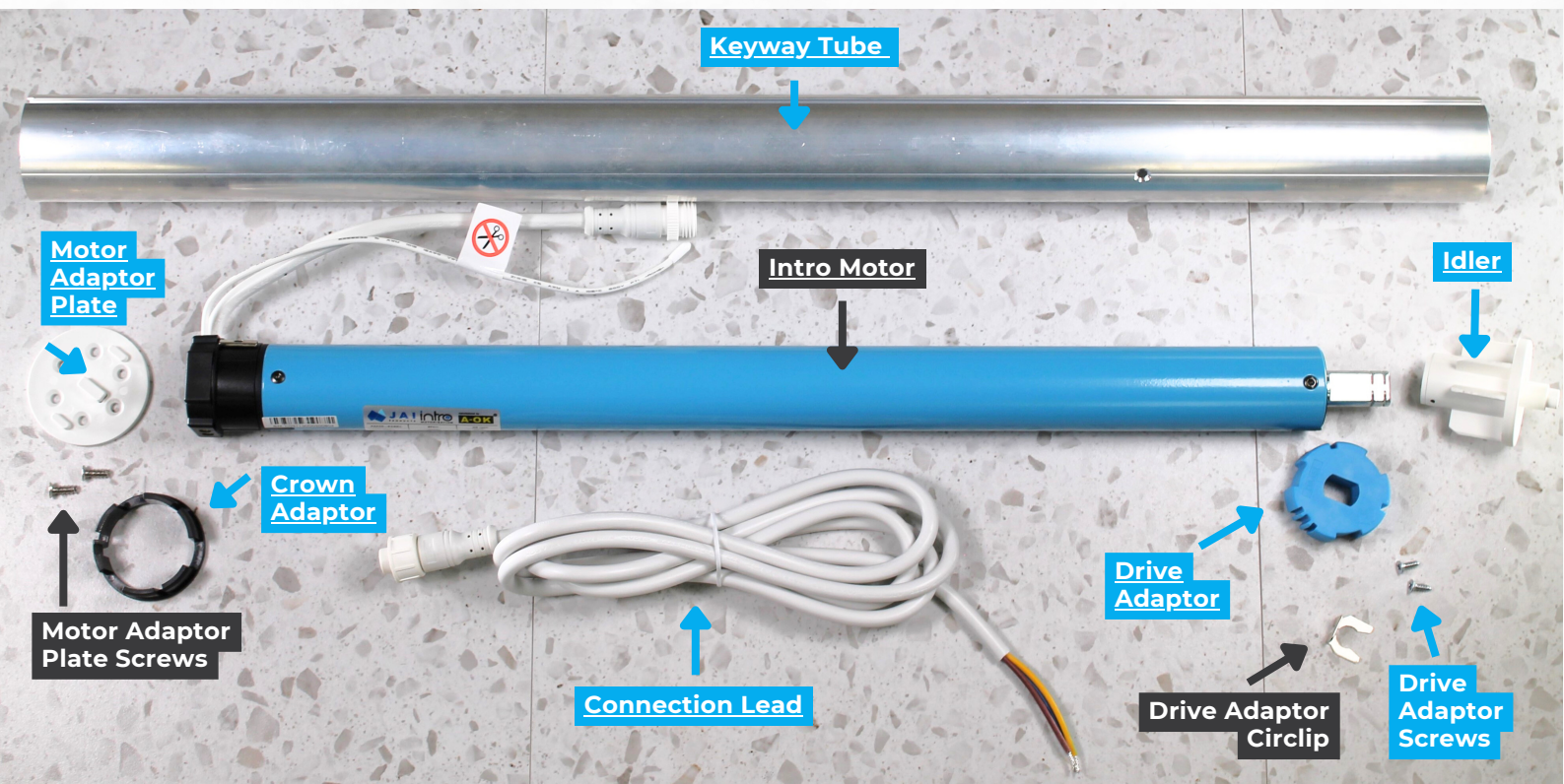

5. Attach the motor adaptor plate to the rear of the motor unit. The screws are provided.

Need support?

Call +61 2 9620 4866

ASSEMBLY INSTRUCTIONS

Works with – S Series | R Series | EL Series | W Series | SOL Series



1. | Slide the crown adaptor onto the motor crown, aligning the tooth with the crown groove.

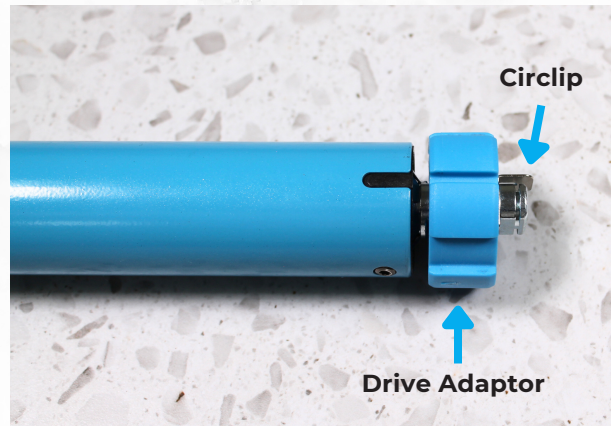

2. | Slide the drive adaptor onto the motor drive shaft and secure it with the circlip.



3. | Attach the motor adaptor plate to the head of the motor with screws provided.

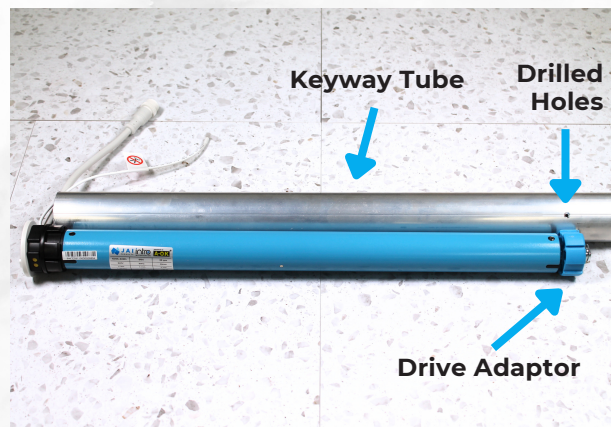

4. | Using the motor measure along the length of the tube from the crown shoulder where the tube stops, to the centre of the drive adaptor. Drill and countersink two holes at 180 degrees to each other.

ASSEMBLY INSTRUCTIONS

Works with – S Series | R Series | EL Series | W Series | SOL Series

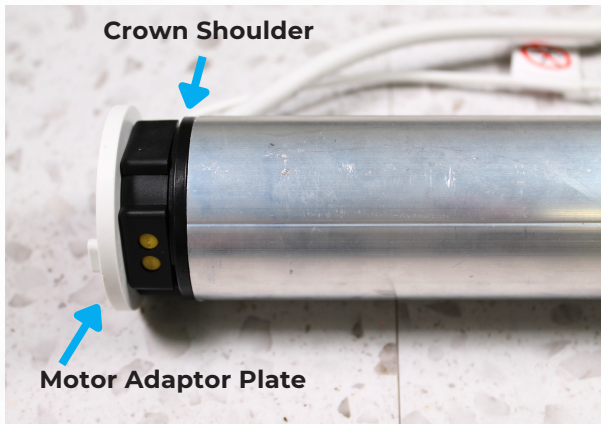

- 5.** | Slide the motor into the tube all the way to the crown shoulder, aligning the grooves of the drive and crown adaptor.

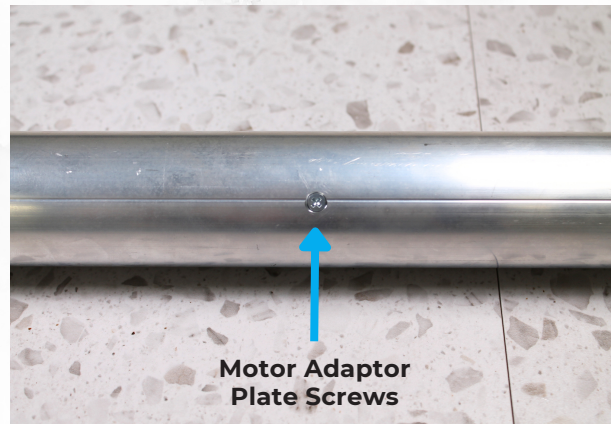

- 6.** | Screw two screws into the drive adaptor through the predrilled holes from step 4.

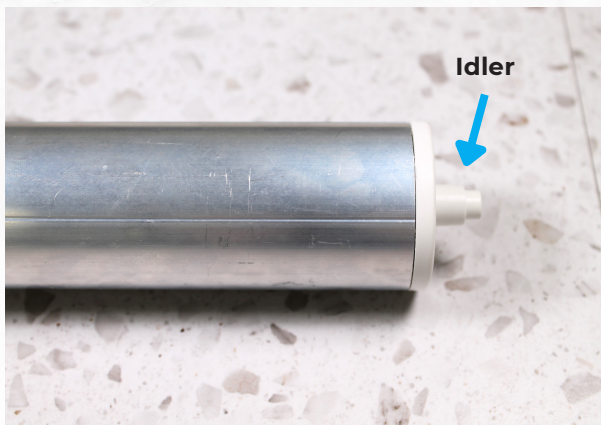

- 7.** | Insert the idler into the opposite end of the tube.

IMPORTANT NOTES

It is highly recommended that all preliminary programming is done in the factory before the fabric is attached to the tube.

Test leads are available to connect the motor to power.

Electronic limit motors have no factory limits. The motor will continue to rotate until you press STOP or a limit has been programmed.

Mechanical limit motors have factory set limit switches to allow 6 to 12 rotations. Care must be taken to allow the motor to travel these rotations.

It is recommended that after programming a motor it is left at the upper limit setting point. This prevents any damage.